

## FX68 SUPER STEREO CHORUS

A stereo multiple effects setup using the FX68 might look like this:

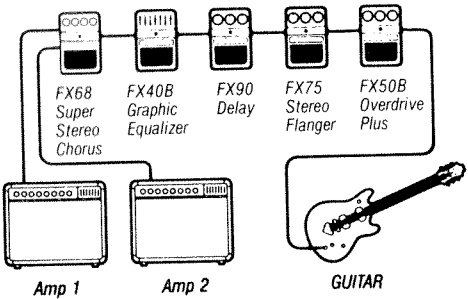

### SPECIFICATIONS

- Input Impedance:** 500K ohms.
- Output Impedance:** 1K ohms.
- Delay Time Range:** 5 to 8 milliseconds
- Sweep Speed:** .8 to 8 Hz
- Bandwidth:** 40Hz to 10K Hz.
- Power Supply:** one 9 volt battery or DOD PS 50 A.C. adapter.
- Size:** 5" x 3" x 2 1/4" (126mm x 77mmx57mm).
- Weight:** 1.2 lbs. (.55 kg).

### CHANGING THE BATTERY

Figure 1: Push battery compartment cover tab down and pull out at top.

Figure 2: Remove used battery. Replace with an EVEREADY® 9 volt No. 216 (NEDA 1604) or EVEREADY® ENERGIZER® 9 volt battery No. 522. Snap on new battery and replace as shown.

Figure 3: Insert compartment cover in groove and push closed to latch.

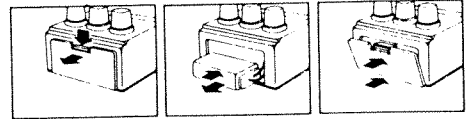

Figure 1      Figure 2      Figure 3

### DOD WARRANTY

1. The warranty registration card must be mailed within ten days after purchase date to validate this warranty.
2. DOD warrants this product, when used solely within the U.S., to be free from defects in material and workmanship under normal use and service.
3. DOD Electronics liability under this warranty is limited to repairing or replacing defective materials that show evidence of defect, provided the product is returned through the original dealer, where all parts and labor will be covered up to a period of three years. The company shall not be liable for any

consequential damage as a result of the product's use in any circuit or assembly.

4. Proof of date of purchase is considered to be the burden of the consumer.
5. If this product is battery operated: Batteries are not covered by this warranty. Please remove weak or dead batteries in order to prevent corrosion damage.
6. DOD reserves the right to make changes in design or make additions to or improvements upon this product without incurring any obligation to install the same on PRODUCTS PREVIOUSLY MANUFACTURED.
7. The foregoing is in lieu of all other warranties, expressed or implied, and DOD neither assumes nor authorizes any person to assume for it any obligation or liability in connection with the sale of this product. In no event shall DOD or its dealers be liable for special or consequential damages or from any delay in the performances of this warranty due to causes beyond their control.

**DOD Electronics Corporation**  
5639 So. Riley Lane, Salt Lake City, UT 84107  
Telephone (801) 268-8400  
FAX (801) 262-4966 Telex 4943178

**INTERNATIONAL DISTRIBUTION:**  
**DOD International**  
10 Cindy Drive, Nashua, NH 03062  
Telephone (603) 888-5230  
FAX (603) 888-6750 Telex 501187

Copyright © 1991 DOD Electronics Corporation

The specifications in this manual are subject to change without notice.

Printed in U.S.A.      Made in the U.S.A.

FX68 V1 2/91

## WHAT THE FX68 SUPER STEREO CHORUS DOES

The FX68 chorus unit is a variable delay unit that gives the impression that more than one instrument is playing. It does this by delaying the sound of the original instrument a small amount (4 to 6 milliseconds) and continuously varying the amount of delay. Continuously varying the delay changes the pitch of the delayed signal. The delayed, slightly pitch shifted signal is mixed with the original signal and results in the chorus effect.

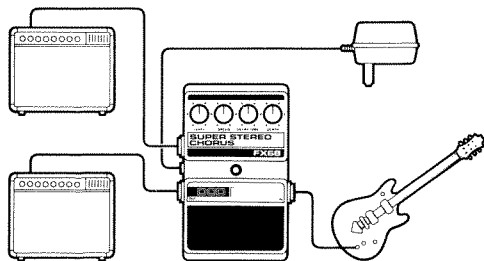

## CONNECTING THE FX68

Connect the INPUT of the FX68 to your guitar with a 1/4-inch mono phone plug. Connect the OUTPUT of the FX68 to your amplifier (or to the input of the other effects if you're using them) with a 1/4-inch mono phone plug.

This unit may be used connected directly to two different amplifiers in a stereo setup, or may be used to create a stereo effect as the last effect unit in a multiple effect setup. To eliminate the need for a 9-volt battery, attach the DOD PS-50 power supply to the 3.5mm A.C. adapter jack.

The FX68 Super Stereo Chorus also features:

- Stereo effect generation for stereo amplifier setups.
- FET switching for "clickless" insertion into the signal path.
- LED indicator shows the status of the effect and battery condition.
- No tools, easy access battery compartment.
- Adapter jack for A.C. operation.
- Rugged die cast metal case.
- Three-year limited warranty.
- Rubber non-skid bottom.

## CONTROLS

**LEVEL:** Mixes in the amount of effect with the dry signal.

**SPEED:** Adjusts the speed of delay variation from .8 cycle per second up to 8 cycles per second. This control is used in conjunction with the DEPTH control to get a good sounding chorus effect.

**DELAY TIME:** This control adjusts the center delay time from which the delay time is varied for the chorus effect.

**DEPTH:** Sets the total amount of delay time variation for the depth (or total change) of the delay sweep.

**FOOT SWITCH:** Switches the chorus effect IN/OUT of the signal path.

**LED INDICATOR:** Lights up when the chorus is enabled.

**JACKS:** INPUT, OUTPUT 1 (This is a single stereo jack on the FX68), A.C. ADAPTER. (Use DOD PS-50 power supply to eliminate the need for batteries.)

## OPERATION OF THE FX68

The FX68 Stereo Chorus effect unit simulates the sound of two instruments playing from one instrument. Pleasing chorus effects are a careful balance of the amount of effect mixed with the dry signal and varying the amount of delay time (DEPTH) and the SPEED at which the delay time variation is swept through. The most useful chorus effects are usually obtained with either a slow sweep SPEED through a large delay time variance (DEPTH) of a faster sweep SPEED through a small delay time variance (a shallow DEPTH). Too fast a sweep SPEED through a wide time variation DEPTH results in an unpleasant warbly "out of tune" sound. Also the DELAY TIME and the DEPTH controls average each other out. When the DELAY TIME and DEPTH controls are set at maximum, the DELAY TIME will have little effect, and when the DELAY TIME and the DEPTH controls are set a minimum, the DEPTH control will seem to have little effect. The best chorus effect results from using two amplifiers in a stereo setup. The sound of the chorus effect is a matter of taste and will change according to the type of music you play.

## IMPORTANT NOTES

- When you're not going to use the FX68 be sure to unplug the INPUT jack so as to not waste the battery.
- If you are not going to use the FX68 for an extended period of time, remove the battery to avoid possible damage to the unit from leaking battery fluids.
- When the FX68 fails to switch in or out or the LED indicator stays lighted, the battery is probably used up and needs to be replaced.
- It is a good idea to keep a fresh battery in the battery compartment while you're playing the FX68 so that even if the A.C. adapter should accidentally come out, your FX68 will continue to work.
- The use of any other A.C. adapter other than a DOD PS-50 will void the warranty of this product.
- Unauthorized repair of the FX68 will void the warranty. Should your chorus unit require service, contact your DOD FX dealer for return/repair information.